

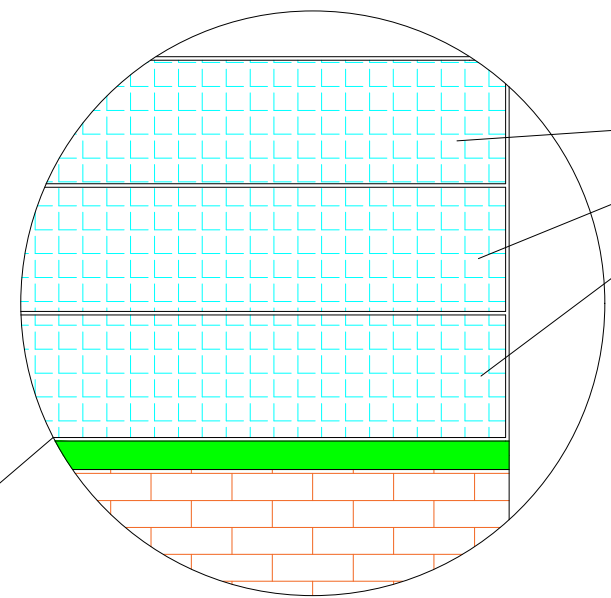

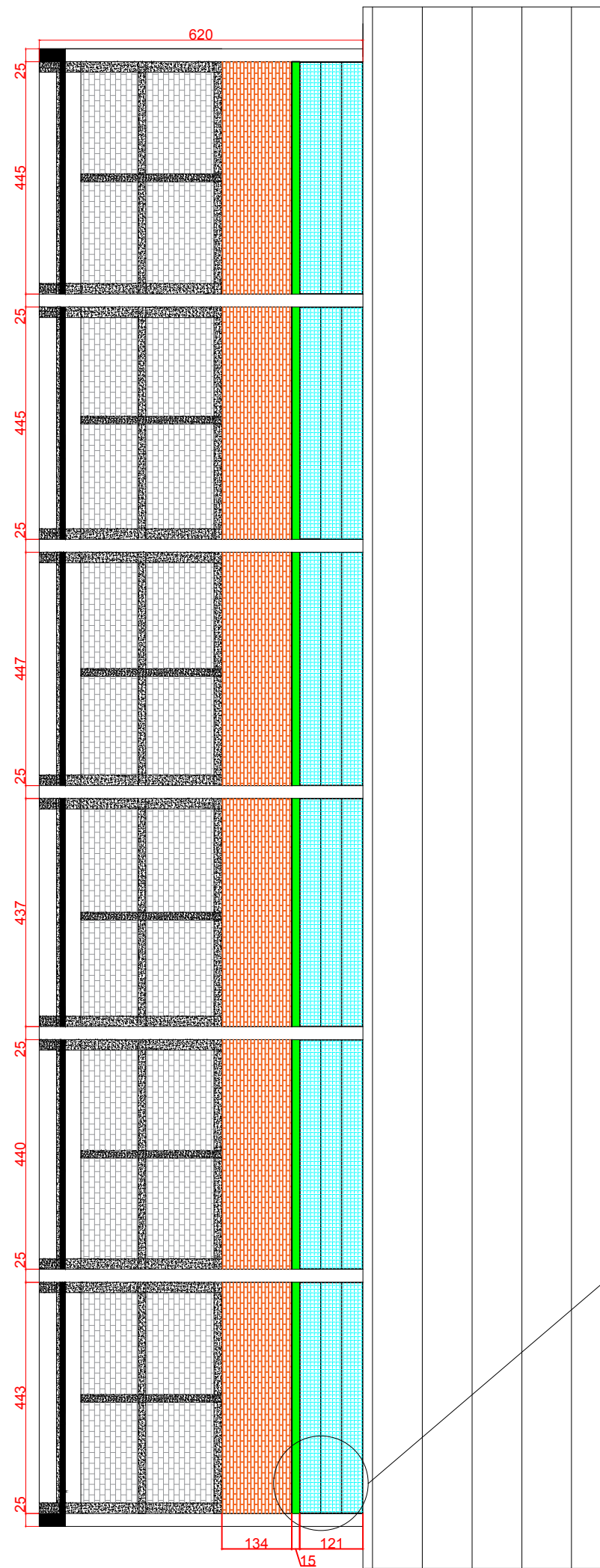

RUA ITAJAÍ

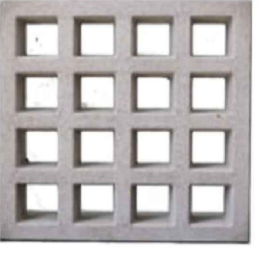
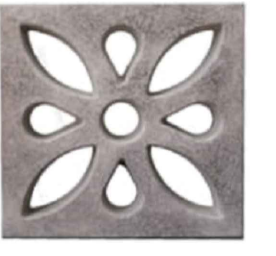

 Cobogós Dimensionado ELEMENTO VAZADO 16 FUROS 39cmx39cmx7cm	 Cobogós Dimensionado ELEMENTO VAZADO FLOR 39cmx39cmx7cm
 Cobogós Dimensionado ELEMENTO VAZADO TACO CHINÊS 39cmx39cmx7cm	 Cobogós Dimensionado ELEMENTO VAZADO 4 PONTAS 39cmx39cmx7cm

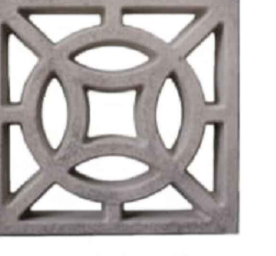
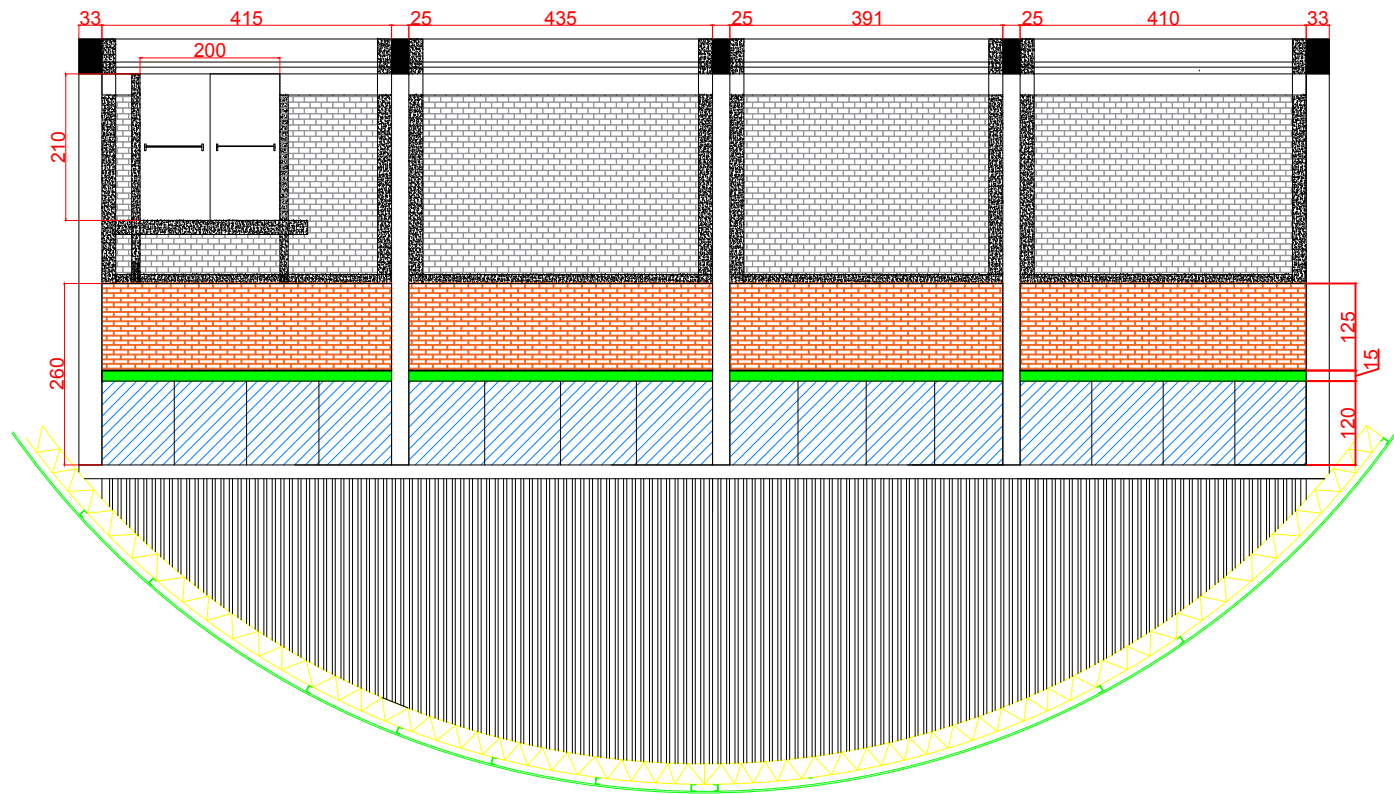
RUA BENJAMIN CONSTANCE

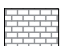
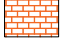
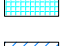

LEGENDA:	
	Alvenaria existente
	Alvenaria à executar
	Cobogó à executar
	Janela
	Contra verga com bloco de canaleta



DEPARTAMENTO MUNICIPAL DE ENGENHARIA			
PROPRIETÁRIO: PREFEITURA MUNICIPAL TENENTE PORTELA			
PROJETO: FECHAMENTO QUADRA POLIESPORTIVA ESCOLA ARCELINO SOARES BUENO		COLABORAÇÃO: Bruna Meneghetti	
LOCAL: Esquina com as ruas Itajaí e Benjamin Constante		DATA: Setembro/2019	
RESPONSÁVEL TÉCNICO: Eliandro Tiecker		REGISTRO CREA: RS180283	
ASSINATURA:		ESCALA: S/E	PRANCHA: 01/01
Responsável Técnico		Proprietário	